

# FEATHER & BLACK

## SIENNA 2 DOOR WARDROBE ASSEMBLY GUIDE

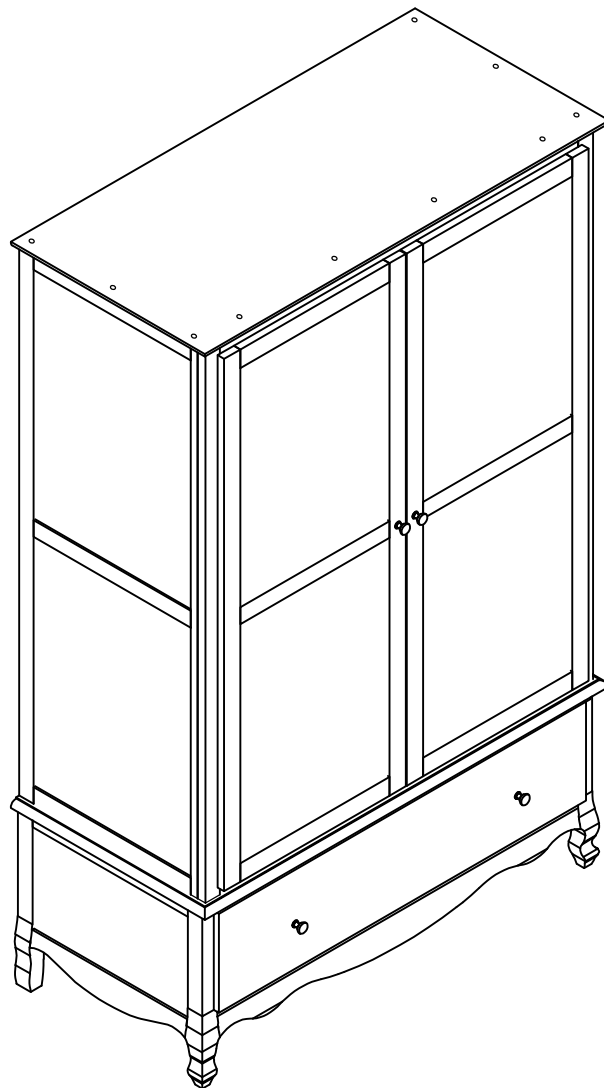

# WELCOME TO THE FEATHER & BLACK COMMUNITY.

Since 2004, we've been dedicated to creating beautifully crafted bedroom furniture that's made to last. We believe your home is a reflection of you, that's why every piece we create is thoughtfully designed and carefully finished.

We hope your new addition feels right at home. If you need anything at all, our team is here to help – simply call 01494 415 399 (option 2), email [customerservices@featherandblack.com](mailto:customerservices@featherandblack.com), or chat to us live at [featherandblack.com](https://featherandblack.com).

We love seeing our designs styled in real homes – so if you're happy to share, tag us on Instagram @featherandblack and use #featherandblack.

From our home to yours, thank you for choosing furniture that's made to be lived in and loved for life.

## THE FEATHER & BLACK TEAM

PLEASE RETAIN THESE ASSEMBLY INSTRUCTIONS FOR FUTURE USE

# FEATHER & BLACK

## SIENNA BEAU 2 DOOR WARDROBE

### BEFORE YOU START

Thank you for purchasing this Sienna Beau 2 Door Wardrobe.

Please read these instructions fully prior to assembly to familiarise yourself with the various stages of construction. Carefully open all packs supplied and check the contents against the parts and fittings check list.

Do not destroy any of the packaging until you are certain that you have all the necessary parts for the assembly.

This item is heavy once assembled. Please try to assemble the item as close as possible to the point of use. Take care when moving the item to avoid personal injury or damage to the product and always lift rather than drag.

There are small components used in the construction of this furniture as well as plastic packaging, these should be kept away from young children whilst assembling.

#### PRODUCT SAFETY

All assembly fastenings should always be tightened properly, and care should be taken to ensure that no fittings are loose.

Periodically check and ensure that all components are in their proper position, free from damage, and that all connectors are tight.

Please note depending on the lighting, positioning and surroundings of your room, the shade of the colour can sometimes appear slightly different. Over a period of time the colour might lighten or fade slightly due to light exposure.

#### PRODUCT CARE

To clean, slightly moisten cloth with water and wipe surfaces. A damp cloth holds dust and cloth. Do not use abrasives or cleaning products which may contain ammonia or solvents.

#### NUMBER OF PEOPLE REQUIRED TO ASSEMBLE

Two people to assemble the product and two people to lift in to position.



#### TIME TO ASSEMBLE



(45 minutes)

#### NECESSARY TOOLS



allen key



#### ANTI-TIP SAFETY KIT

We recommend using the supplied kit to attach all draws and wardrobes to the wall to avoid any risk of tipping in use.

Please ensure the correct wall fixing for your wall (not supplied).

# FEATHER & BLACK

## SIENNA BEAU 2 DOOR WARDROBE

### COMPONENTS SUPPLIED (NOT ACTUAL SIZE)

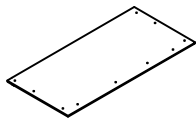

Ref: A - Top Panel  
Dimension (mm): 1250x610x26  
Quantity: 1 pc  
Box Number: 3

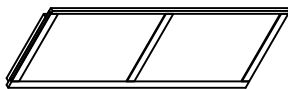

Ref: B - Left Side Panel  
Dimension (mm): 1474x551x46  
Quantity: 4 pcs  
Box Number: 3

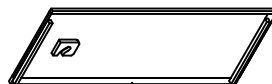

Ref: C - Right Side Panel  
Dimension (mm): 1474x551x46  
Quantity: 4 pcs  
Box Number: 3

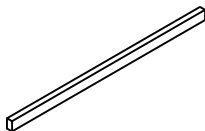

Ref: D - Support Bar  
Dimension (mm): 1185x35x20  
Quantity: 1 pc  
Box Number: 2

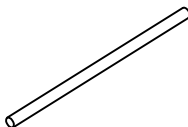

Ref: E - Hanger Pole  
Dimension (mm): Ø29x1150  
Quantity: 1 pc  
Box Number: 2

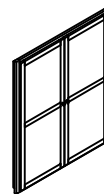

Ref: F - Door Frame  
Dimension (mm): 1199x1474x60  
Quantity: 1 pc  
Box Number: 2

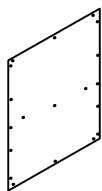

Ref: G - Back Panel  
Dimension (mm): 1432x1183x5  
Quantity: 1 pc  
Box Number: 2

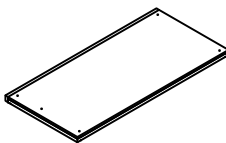

Ref: H - Bottom Panel  
Dimension (mm): 1155x551x35  
Quantity: 1 pc  
Box Number: 3

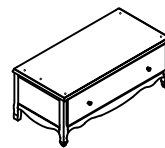

Ref: J - Base  
Dimension (mm): 1250x610x500  
Quantity: 1 pc  
Box Number: 1

0cm 1 2 3 4 5 6 7 8 9 10 11 12 13 14 15 16 17 18



# FEATHER & BLACK

## SIENNA BEAU 2 DOOR WARDROBE

### FIXTURES AND FITTINGS SUPPLIED (NOT ACTUAL SIZE)

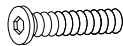

Ref: K - Bolt  
Dimension (mm): M6x35  
Quantity: 32 pcs  
Box Number: 1

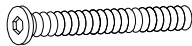

Ref: L - Bolt  
Dimension (mm): M6x65  
Quantity: 6 pcs  
Box Number: 1



Ref: M - Spring washer  
Dimension (mm): M6x10x1.2  
Quantity: 38 pcs  
Box Number: 1



Ref: N - Flat washer  
Dimension (mm): M6x16x1.5  
Quantity: 38 pcs  
Box Number: 1



Ref: P - Allen Key  
Dimension (mm): M4x110  
Quantity: 1 pc  
Box Number: 1

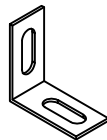

Ref: Q - Bracket L  
Dimension (mm): 62x40x25  
Quantity: 2 pcs  
Box Number: 1

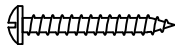

Ref: R - Screws  
Dimension (mm): #4x20  
Quantity: 19 pcs  
Box Number: 1

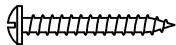

Ref: S - Screws  
Dimension (mm): #4x20  
Quantity: 2 pcs  
Box Number: 1

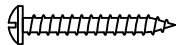

Ref: T - Screws  
Dimension (mm): #4x30  
Quantity: 2 pcs  
Box Number: 1



Ref: V - Flat washer  
Dimension (mm): M6  
Quantity: 4 pcs  
Box Number: 1



Ref: W - Explosion Screw  
Dimension (mm): 11x38  
Quantity: 2 pcs  
Box Number: 1

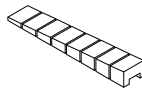

Ref: X - Alignment Wedges  
Dimension (mm): 100x20  
Quantity: 2 pcs  
Box Number: 1

0cm 1 2 3 4 5 6 7 8 9 10 11 12 13 14 15 16 17 18



# FEATHER & BLACK

## SIENNA BEAU 2 DOOR WARDROBE

1. Secure the Bottom Panel (H) to the Side Panel (B).  
Support Bar (D) as shown.

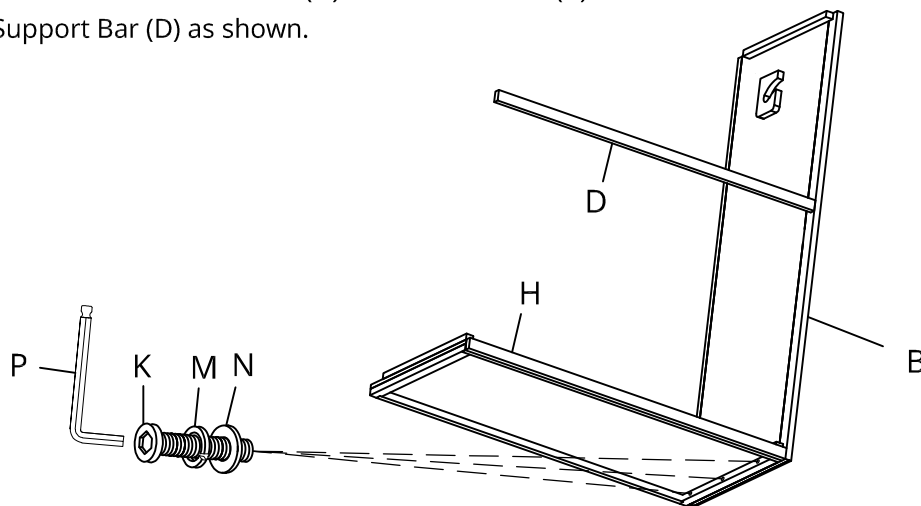

K: Bolt M6x35 (mm)



M: Spring washer



N: Flat washer



P: Allen key

2. Secure the Side Panel (C) to the Bottom Panel (H) and Support Bar (D).  
Secure the Top Panel (A) to the Side Panel (B&C) as shown.

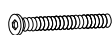
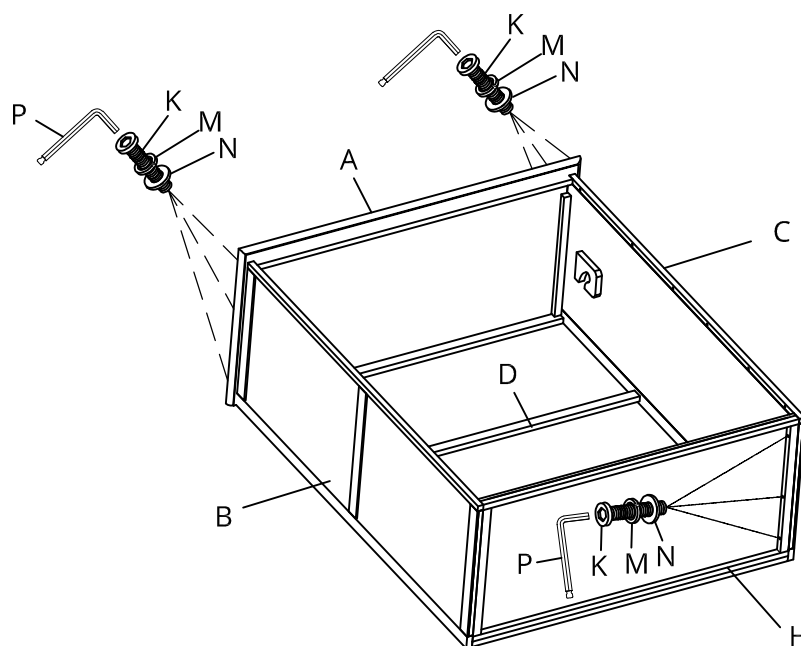

K: Bolt M6x35 (mm)



M: Spring washer



N: Flat washer



P: Allen key

# FEATHER & BLACK

## SIENNA BEAU 2 DOOR WARDROBE

3. Lower the Door Frame (F) into position.

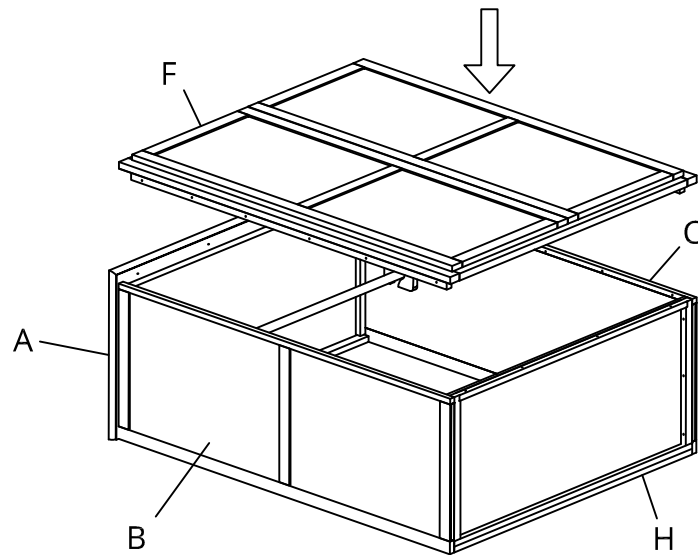

4. Secure Door Frame (F) to the Panel Top (A) and Bottom panel (H).

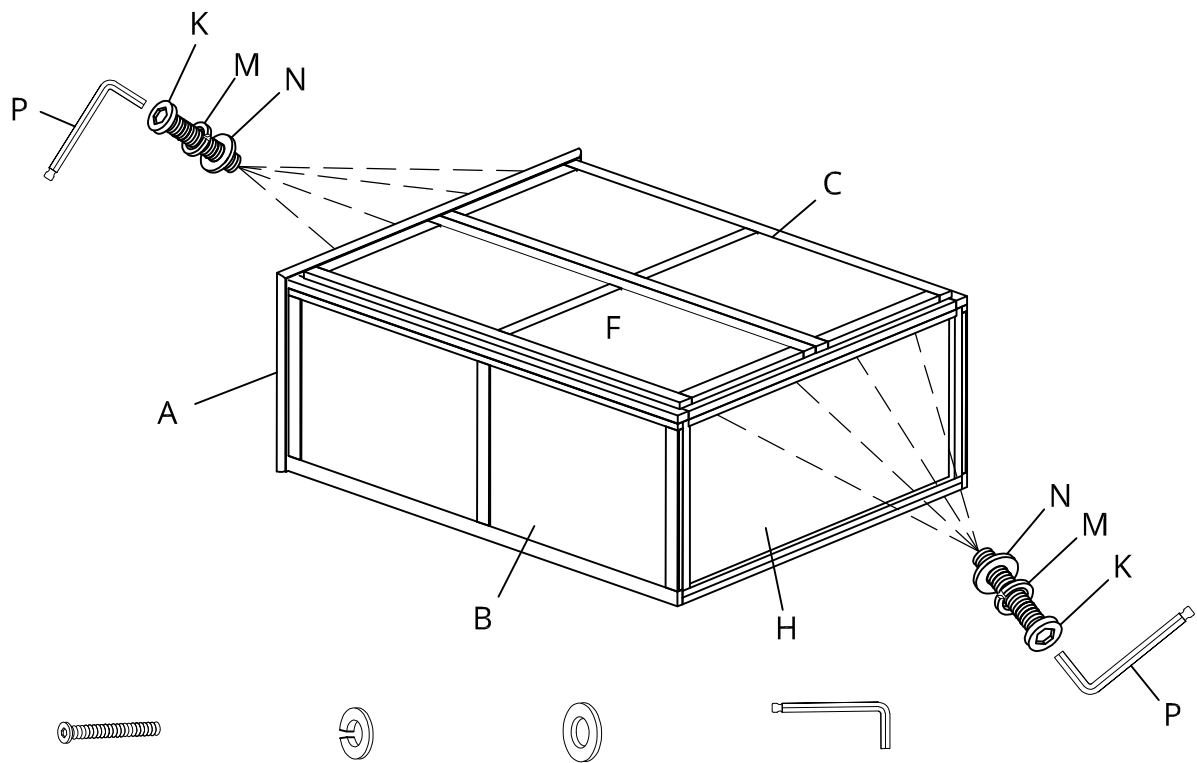

K: Bolt M6x35 (mm)

M: Spring washer

N: Flat washer

F: Allen key

# FEATHER & BLACK

## SIENNA BEAU 2 DOOR WARDROBE

5. Secure Door Frame (F) by opening doors and fixing internally to Side Panel (B,C).

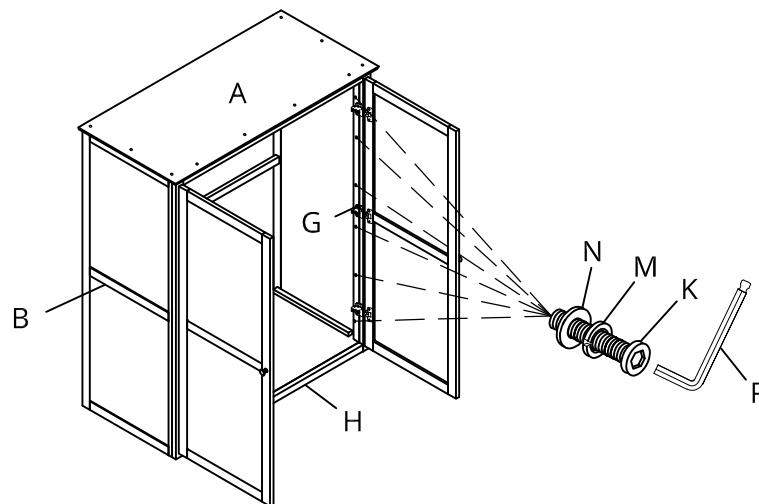

K: Bolt M6x35 (mm)



M: Spring washer



N: Flat washer



P: Allen key

6. Secure the Top Section (A, B, C, F) onto the Base (J).

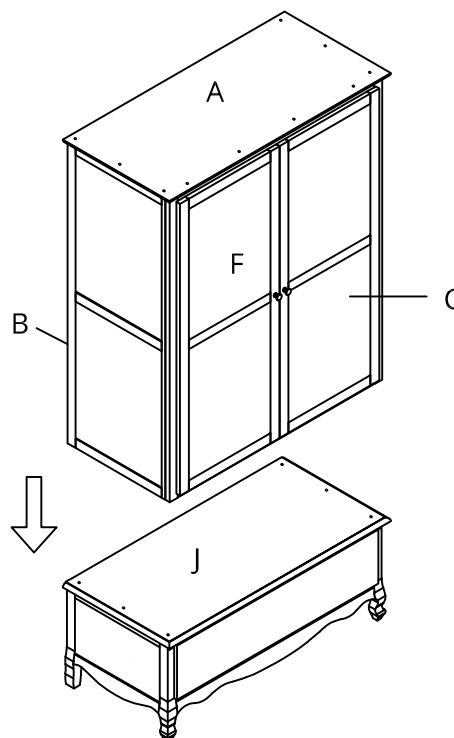



# FEATHER & BLACK

## SIENNA BEAU 2 DOOR WARDROBE

7. Secure the Top to the Base inside the wardrobe as show below.  
Then secure the Hanger Pole (E) as show below.

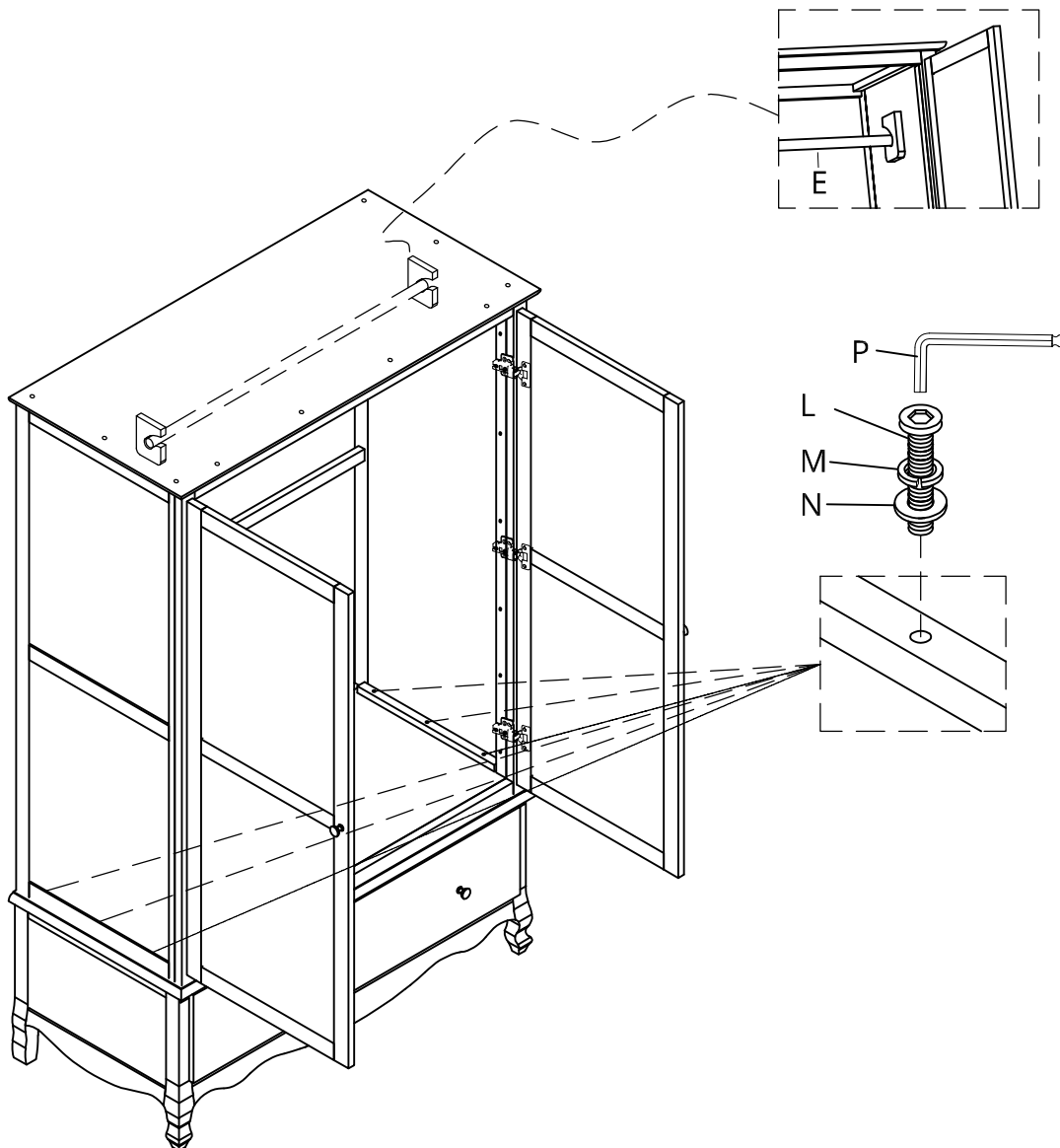

L: Bolt M6x65  
(mm)



M: Spring  
washer



N: Flat  
washer



P: Allen key

# FEATHER & BLACK

## SIENNA BEAU 2 DOOR WARDROBE

8. Before attaching the back panel ensure the wardrobe base is level using the wedges provided.  
Attach the back panel to secure the wardrobe door alignment.

If further door adjustment is required, adjust using the hinges as show below.

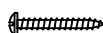
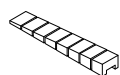
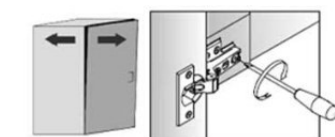
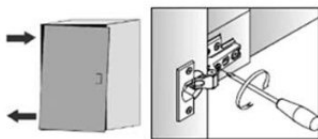
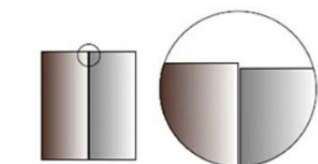
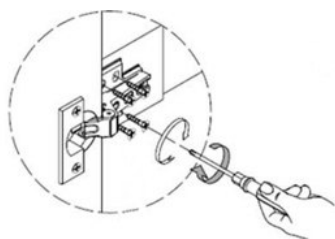

X: Alignment Wedges

R: Screws

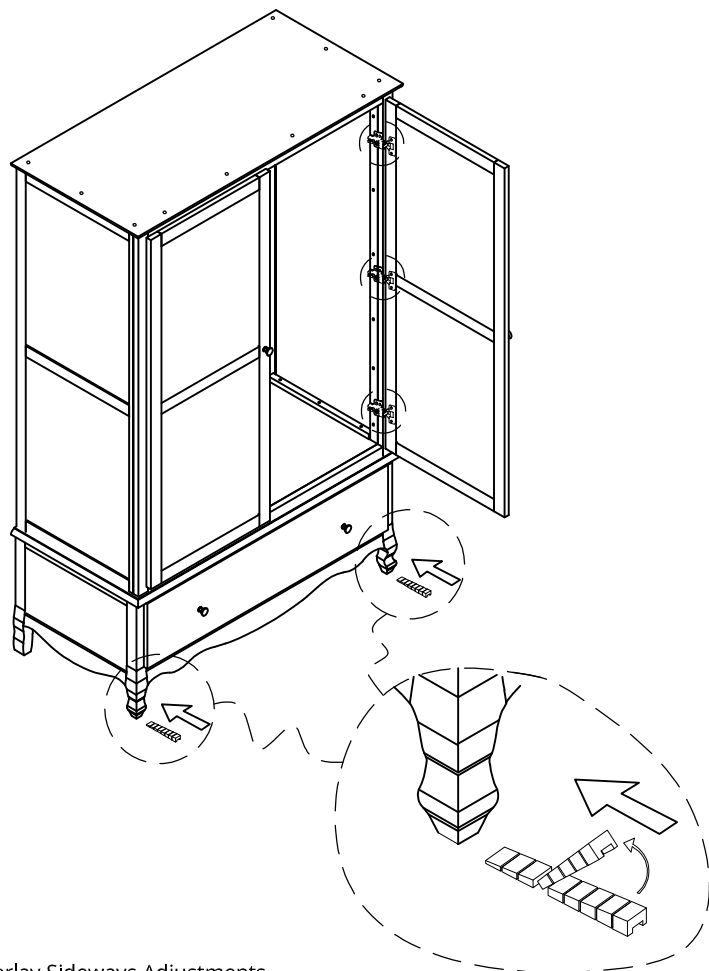

### Overlay Sideways Adjustments

This adjustment system allows the door to be moved sideways without changing the gap behind the door.

Turn screw clockwise: Door overlay decreases (-).

Turn screw counter clockwise: Door overlay increases (+).

### Depth Adjustment

Correct the distance between door and cabinet side by turning the adjustment cam.

Turn counter clockwise to increase distance.

Turn clockwise to decrease distance.

# FEATHER & BLACK

## SIENNA BEAU 2 DOOR WARDROBE

9.

**\*WARNING: it is strongly recommended that you anchor this product to a wall.**

- Attach the metal bracket to the top using the provided screws and bracket. Then secure the bracket to the wall using screws through the barcket. (wall screws not included).
- As wall materials vary, screws for fixing to the wall are not included.

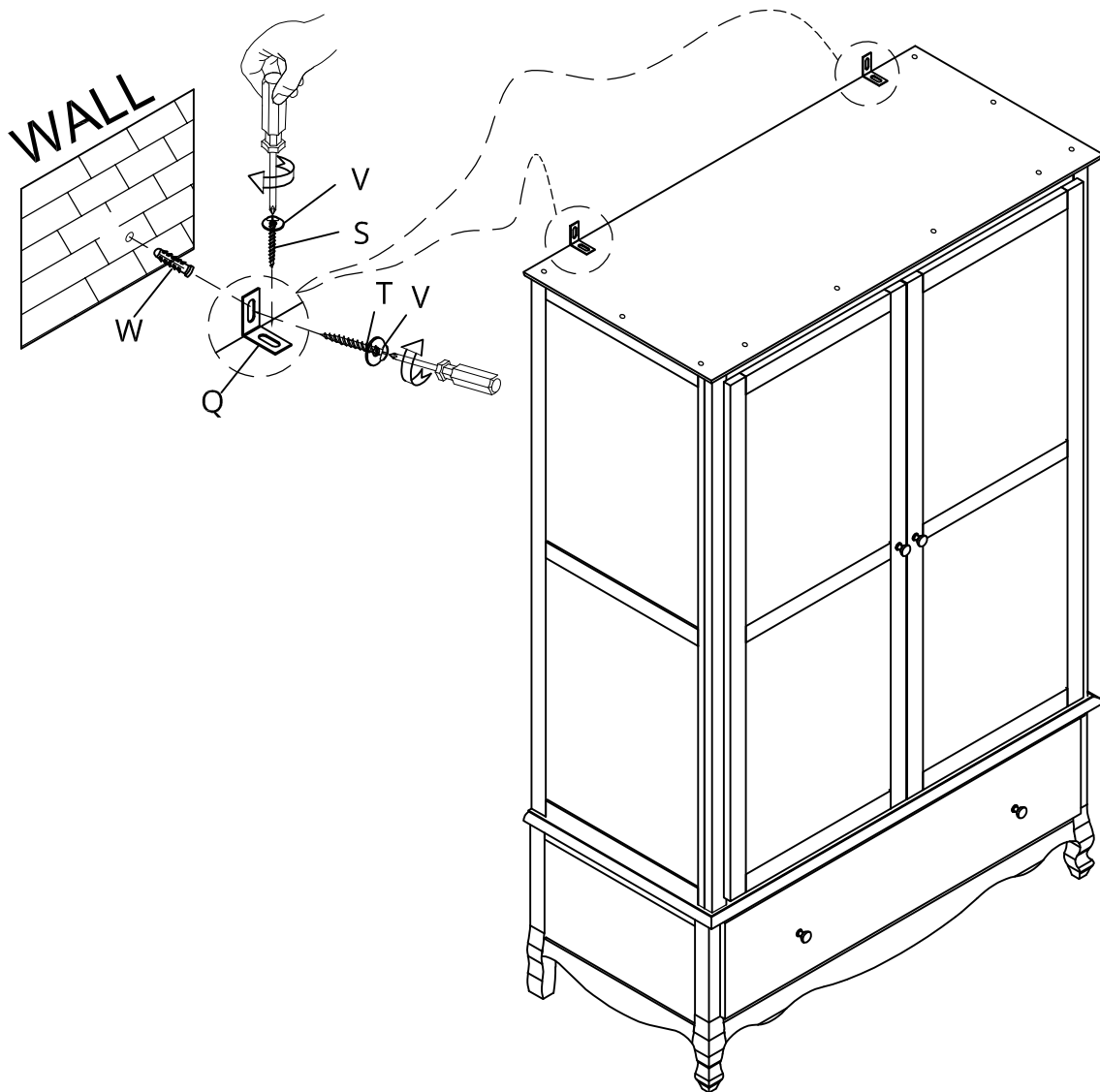

Q: Bracket L

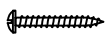

S: Screws



T: Screws



V: Flat  
washer



W: Explosion  
Screw

# FEATHER & BLACK

[featherandblack.com](http://featherandblack.com)